

Grooved Coupling

Installation Manual

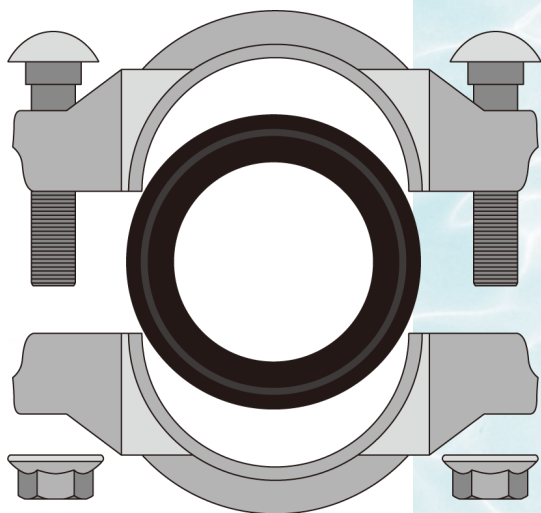

**One-Stop Industrial Water
Treatment Purchase Partner**

Hengshui Snøwate Environmental Technology Co., Ltd.

We integrate upstream supply chain products of the water treatment industry. In addition, we work with renowned suppliers and manufacturers. As a result, we can continuously supply high-quality water treatment components and systems for customers across the world to meet the needs of a wide range of applications, thereby optimizing water resources and promoting the sustainable development of the global environment.

Grooved Coupling Installation Diagram

• Step 1

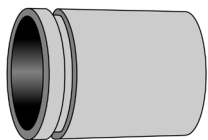

Check whether the groove meets the standard before installation.

Remove the burrs, rust, oil, paint and other impurities on the tube and sealing ring.

Pipe ends must be clean and smooth, free from unevenness.

Step 2

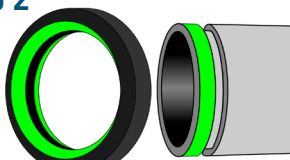

Apply silicone lubricant to the end of pipe, outer surface of rubber ring and sealing lip, and do not use petroleum-based lubricant.

Precautions

- For cut grooved pipes or roll grooved pipes, specifications are based on groove diameter, the groove depth is just a reference dimensions.
- Before installation, please ensure that the outer diameter of the pipe reaches the standard value or above. If the outer diameter of the pipe is lower than the standard value, water leakage will easily occur.
- To achieve the best performance, proper bolt torque is required. Excessive torque will damage the clamp and bolts, causing the pipe connection to fall off, causing heavy property loss and serious personal injury!

Step 3

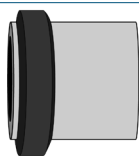

Put the sealing rubber into the sealing part of a steel pipe.

Step 4

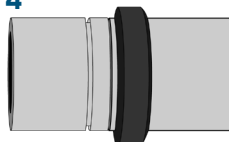

Align the two steel pipes.

Description of pressure rating:

S30 series 0-600 psi;

S80 series 0-1200 psi;

S160 series 0-2322 psi

*Special note

When used at the outlet of high-pressure pumps and plunger pumps, models with one grade higher than the operating pressure must be selected.

(For example: If the actual pressure at the pump outlet is 1200 psi (S80), it is recommended to choose the clamp of the S160 series)

Step 5

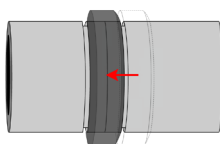

After the two steel pipes are aligned, pull back the rubber ring to the center of the pipe end, so that the rubber ring is just located at the sealing part outside the groove, and ensure that the rubber ring stretches naturally without distortion.

Step 6

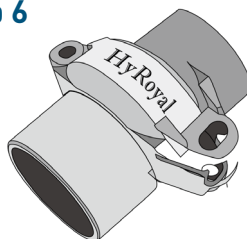

Make sure that the tube clamps are aligned with the grooves on both sides.



Scan the code to get the installation video



Step 7

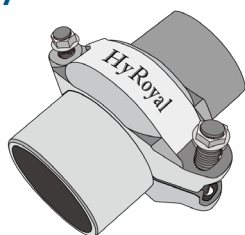

Thread the bolts and nuts

Step 8

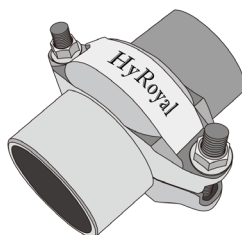

Tighten the nuts evenly from both sides with a torque wrench until the pipe clamp is tightly fastened to the pipe. The gap at the rigid joint must be equal on both sides, and there is no gap at the flexible joint. Rubber rings should not be seen from the outside of rigid and flexible joint.

Notes on Installation of Grooved Short Pipes

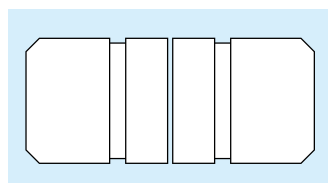
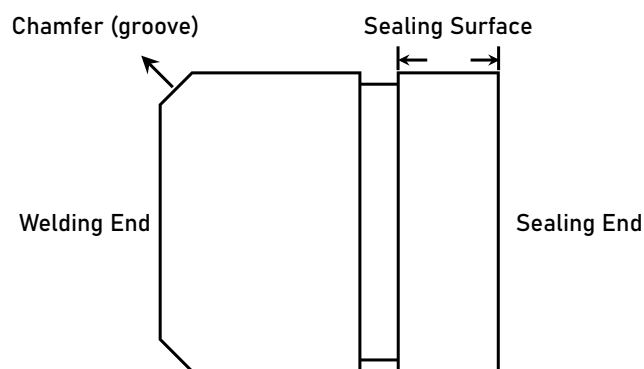

✓ Correct View

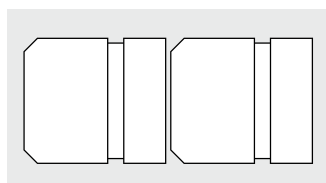

✗ Error View

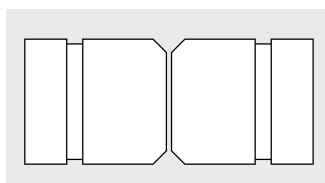

✗ Error View

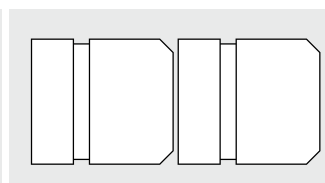

✗ Error View

Breaking Torque Table for Austenitic Stainless Steel Bolts and Screws (M1.6-M16)

Thread	Breaking Torque (Nm)		
	Performance Level		
	50	70	80
M1.6	0.15	0.2	0.24
M2	0.3	0.4	0.48
M2.5	0.6	0.9	0.96
M3	1.1	1.6	1.8
M4	2.7	3.8	4.3
M5	5.5	7.8	8.8
M6	9.3	13	15
M8	23	32	37
M10	46	65	74
M12	80	110	130
M16	210	290	330

Snowate

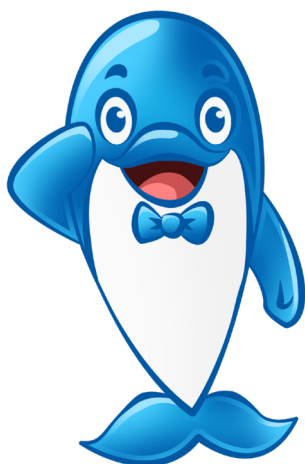

Ms Snow Zhao

snow@snowate.com

Mobile: +86-15030811699

(WhatsApp, WeChat, Skype, Viber)

Hengshui Snowate Environmental Technology Co., Ltd.
www.snowate.com

Website

