



KV series ball valve is a type of valve with a spherical body that controls the flow of the medium by rotating a hole inside the sphere. It features a simple structure, convenient operation, and flexible switching. It can be quickly opened and closed, swiftly cutting off the flow of the medium, with low fluid resistance and good flow regulation performance. Additionally, it has good sealing performance, making it suitable for high pressure, high temperature, and corrosive medium applications.

KVN New Compact Ball Valve-Reverse buckle

Description

- **Material:** UPVC, CPVC, PPH, PVDF
- **Size:** 2-1/2" - 4" , 75-110mm, DN65-DN100
- **Standard:** ANSI, DIN, JIS, and CNS
- **Joint:** Socket end, and thread end (NPT, BSPF, and PT)
- **Working pressure:** 150 psi
- **Operation temperature:**
 - UPVC (5 °C to 55 °C)
 - CPVC & PPH (5 °C to 90 °C)
 - PVDF (-20 °C to 120 °C)
- **Color:**
 - **Handle color:** Red, and blue
 - **Body color:** UPVC (dark gray), CPVC (light gray), PPH (beige), and PVDF (ivory white)



Feature

- Excellent air-tightness
- Low torque
- Replaceable handle, easy to operate, and economical
- Nano-modified raw material to improve pressure resistance and impact resistance
- Adding anti-UV absorbers and antioxidants to improve weathering and aging resistance
- 100% working pressure testing

Material List

S/N	Part	Specification	Qty.
44	O-ring	EPDM/VITON	2
41	O-ring	EPDM/VITON	2
18	Logo	ABS	1
17	Union end	UPVC/CPVC/PPH/PVDF	2
10	Handle	ABS	1
07	Seat seal	TPV	2
06	Ball	UPVC/CPVC/PPH/PVDF	1
05	Stem	UPVC/CPVC/PPH/PVDF	1
01	Body	UPVC/CPVC/PPH/PVDF	1

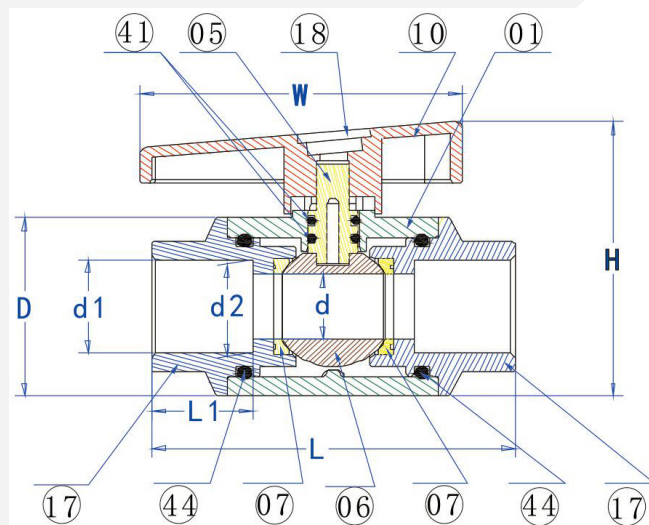

Unit: mm

Size	d	d1				d2				D	L	L1	H	W	Operating Torque (N · m)
		ANSI	DIN	JIS	CNS	ANSI	DIN	JIS	CNS						
2-1/2" (65)	65	73.38	75.30	76.60	76.70	72.85	75.10	75.68	75.90	119.00	197.50	53.00	158.80	150.00	8.00
3" (80)	75	89.31	90.30	89.60	89.70	88.70	90.10	88.55	88.90	135.00	207.60	51.00	191.00	200.00	15.00
4" (100)	97	114.76	110.40	114.70	115.00	114.10	110.10	113.60	113.80	174.00	254.00	60.00	237.00	260.00	40.00