

## LZB-DK300 Series Rotameter

SR LZB-DK300 series rotameter is designed for high-precision flow measurement. The measuring tube is a glass conical tube supported by four columns in the upper and lower bases. LZB-DK300T rotameter has an adjustable valve, which can control the flow rate of the fluid. LZB-DK300 series rotameter is mainly used in chemical analysis instruments and experimental research equipment.

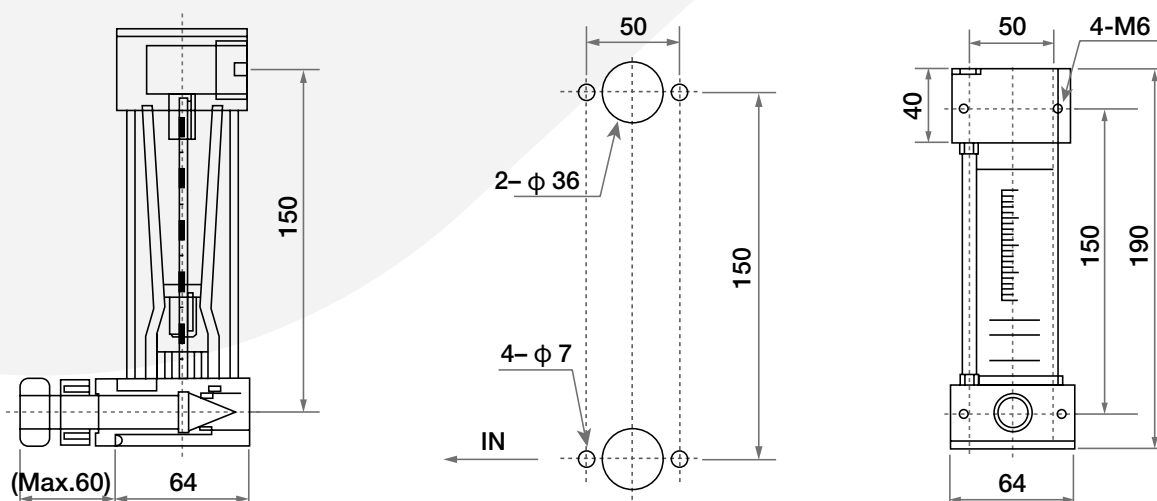

### Drawing and dimensions



### Technical parameters

Model	Measurement Range (L/min)		Interface Thread	Accuracy (±%)	Allowed Measured Medium	
	20 °C Water	20 °C Air: 101325 Pa			Operating Temperature (°C)	Operating Pressure (MPa)
SR LZB-DK300 SR LZB-DK300T	1-10	40-400	BSP 1/2" NPT 1/2" BSP 3/4" NPT 3/4"	5	PVC: ≤ 60 °C PTFE: ≤ 80 °C Stainless steel: ≤ 120 °C	≤0.6
	2-20	60-600		5		≤0.6
	3-30	90-900		5		≤0.6
	4-40	120-1200		5		≤0.6
	5-50	150-1500	BSP 3/4" NPT 3/4"	5		≤0.6
	12-60	400-1800		5		≤0.6